

# AK Series

- 24mm/□42mm/□60mm/□85mm Shaft type
- 60mm/□85mm Shaft type+Brake built-in type

## Features

- Compact design and light weight with high accuracy, speed and torque
- Suitable for small-sized equipment applications
- Brake □60mm, □85mm of shaft type for compact equipment (AK-B Series)
- Brake force is released (AK-B Series) when applying power on brake wire. (24VDC non-polar type)
- Cost-effective

Please read "Caution for your safety" in operation manual before using.

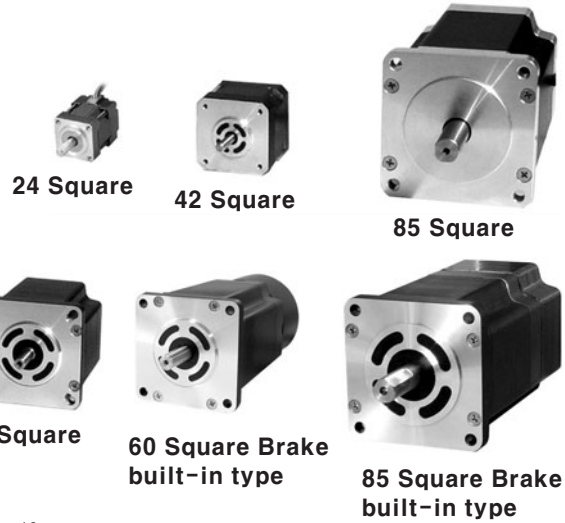

## Dimensions

### □24 Square

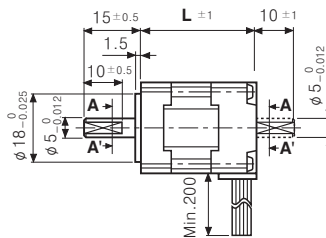
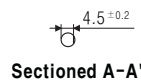
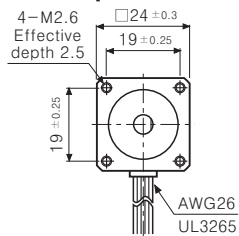

(Unit:mm)

MODEL	L
02K-S523(W)	30.5
04K-S525(W)	46.5

※These dimensions are for dual shaft models. For single shaft models, ignore dotted line (.....) part.

### □42 Square

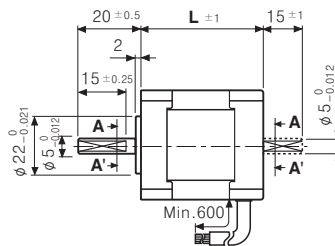
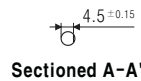
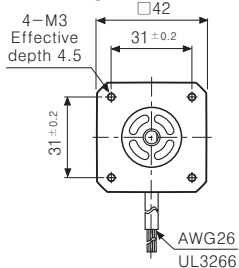

(Unit:mm)

MODEL	L
A1K-S543(W)-□	33
A2K-□544(W)-□	39
A3K-S545(W)-□	47

※These dimensions are for dual shaft models. For single shaft models, ignore dotted line (.....) part.

### □60 Square

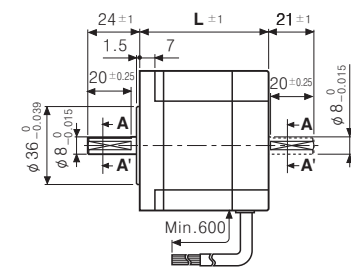
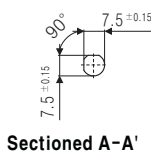
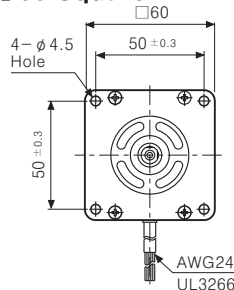

(Unit:mm)

MODEL	L
A4K-□564(W)-□B	48.5
A8K-□566(W)-□B	59.5
A16K-□569(W)-□B	89

※These dimensions are for dual shaft models. For single shaft models, ignore dotted line (.....) part.

<Shaft type>

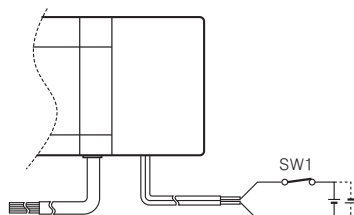

※Brake is non-polar "B" type.  
Be sure to observe rated excitation voltage (24VDC).  
※SW1 ON-Brake release / SW1 OFF-Brake execute

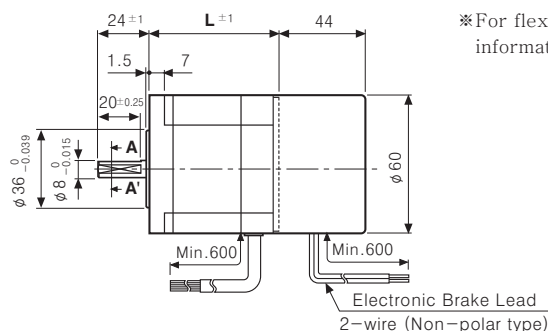

※For flexible coupling(ERB series) information, refer to F-62 page.

<Brake built-in type>

# 5-Phase Stepping Motor

## Dimensions

◎85 Square

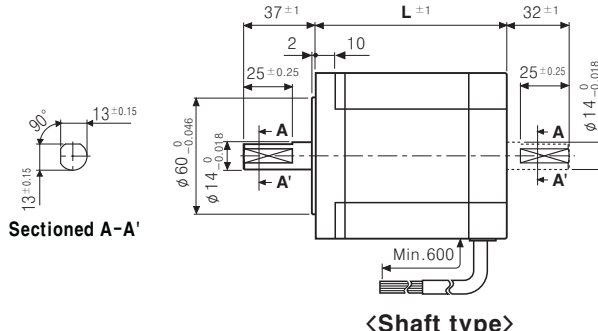
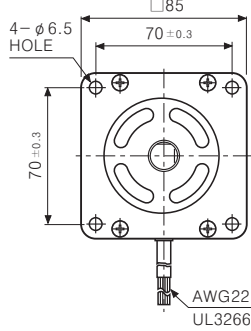

(Unit:mm)

MODEL	L
A21K-□596(W)-□B	68
A41K-□599(W)-□B	98
A63K-□5913(W)-□B	128

\*These dimensions are for dual shaft models. For single shaft models, ignore dotted line (.....) part.

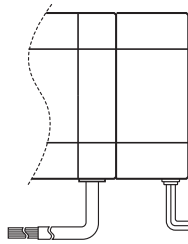

\*Brake is non-polar "B" type.

Be sure to observe rated excitation voltage (24VDC).

\*SW1 ON-Brake Release / SW1 OFF-Brake Execute

<Shaft type>

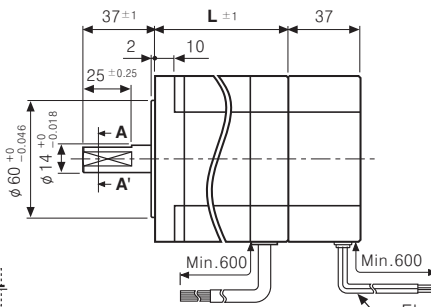

<Brake built-in type>

Electronic Brake Lead  
2-wire (Non-polar type)

## Characteristic

●02K-S523

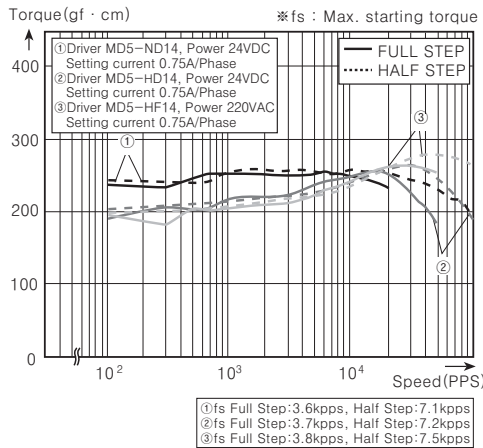

●04K-S525

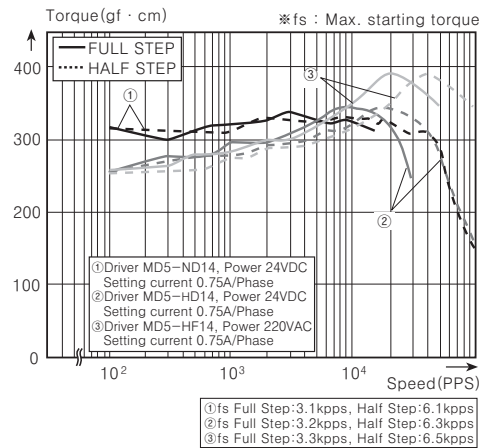

●A1K-S543

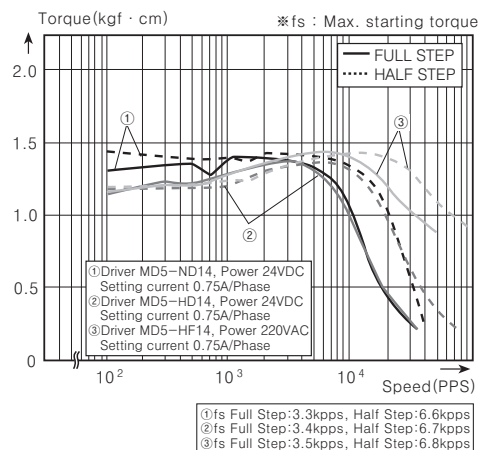

●A2K-□544

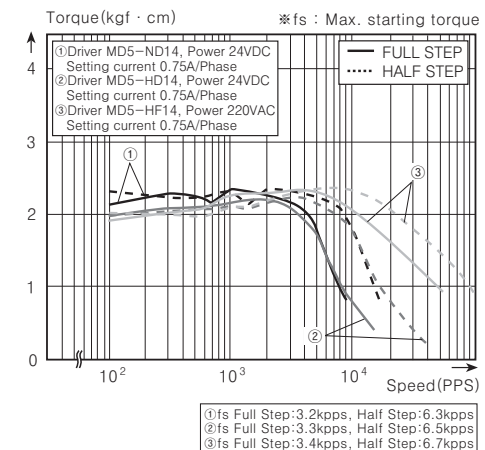

(A) Photo electric sensor

(B) Fiber optic sensor

(C) Door/Area sensor

(D) Proximity sensor

(E) Pressure sensor

(F) Rotary encoder

(G) Connector/Socket

(H) Temp. controller

(I) SSR/Power controller

(J) Counter

(K) Timer

(L) Panel meter

(M) Tacho/Speed/Pulse meter

(N) Display unit

(O) Sensor controller

(P) Switching power supply

(Q) Stepping motor & Driver & Controller

(R) Graphic/Logic panel

(S) Field network device

(T) Production stoppage models & replacement

# AK Series

## Characteristic

### ●A3K-S545

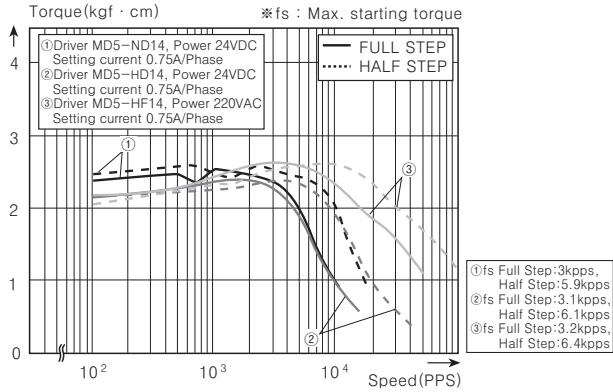

### ●A4K-M564 / A4K-M564-B

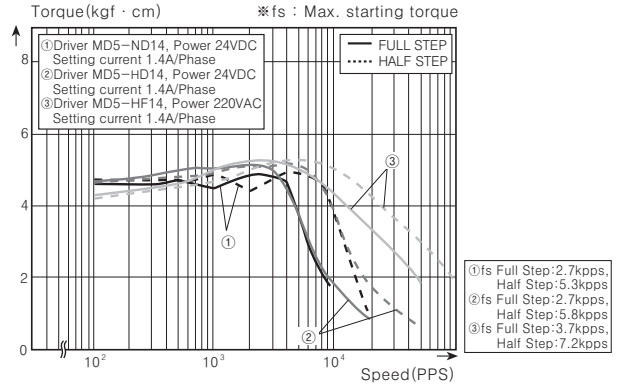

### ●A8K-M566 / A8K-M566-B

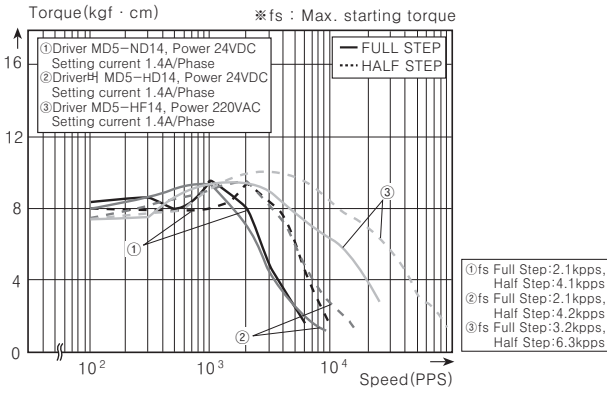

### ●A16K-□569 / A16K-□569-B

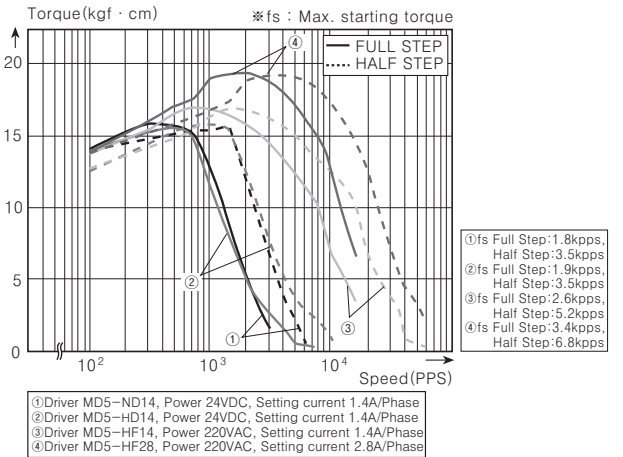

### ●A21K-□596 / A21K-□596-B

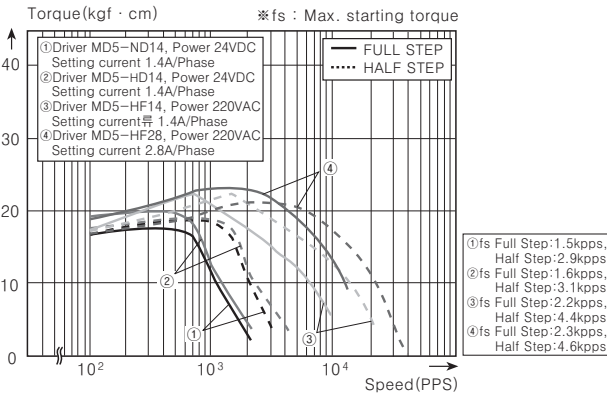

### ●A41K-□599 / A41K-□599-B

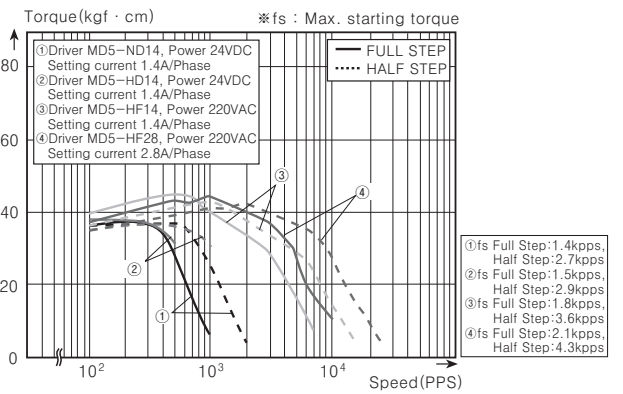

### ●A63K-G5913 / A63K-G5913-B

